

Sold

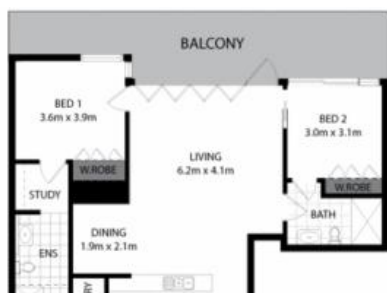

## N704, 5 Sterling Circuit, Camperdown



### TRIO: STUNNING EAST FACING APARTMENT, CITY VIEWS

Enjoy the excitement of inner west living in the heart of all the action.

This exceptional two bedroom apartment has stunning city views as well as space to spare. The apartment boasts a wide timber-decked loggia and study, a generous sized kitchen, storage and laundry, plus a security car space. Buyers are encouraged to act quickly as this property will not remain on the market for long.

#### Features:

- Two spacious bedrooms with twin ensuite bathrooms
- Built in robes, master bedroom with walk through
- Light filled and stylish, signature floor plan
- Dedicated study alcove, fitted with media
- Superior designer finishes.
- Reverse cycle zoned air
- 2.7 meter ceiling height
- Trio's residents enjoy all the benefits of City Quarter's established community, including an indoor heated swimming pool and gymnasium and a 50m outdoor pool, café, restaurant.

Surrounded by Glebe, Newtown and Annandale Villages your only moments to the very best of lifestyle options, minutes to RPAH, CBD and transport links.

Become a proud owner in this award winning development

Trio recently received the following accolades:

Winner for High Density, UDIA National Awards 2010

Joint Winner for High Density UDIA NSW 2010

2 2 1

**Price**

SOLD

**Property Type**

Residential

**Property ID**

1812

**Land Area**

0 m2

#### Agent Details

Emlyn Walters - 0405 606 025

emlyn@greenciff.com.au

#### Office Details

Greenciff Camperdown Office

Shop 1 1 Sterling Cct Camperdown NSW

2050 Australia

02 8262 8262

**greenciff**  
Inner city specialists