

Sold

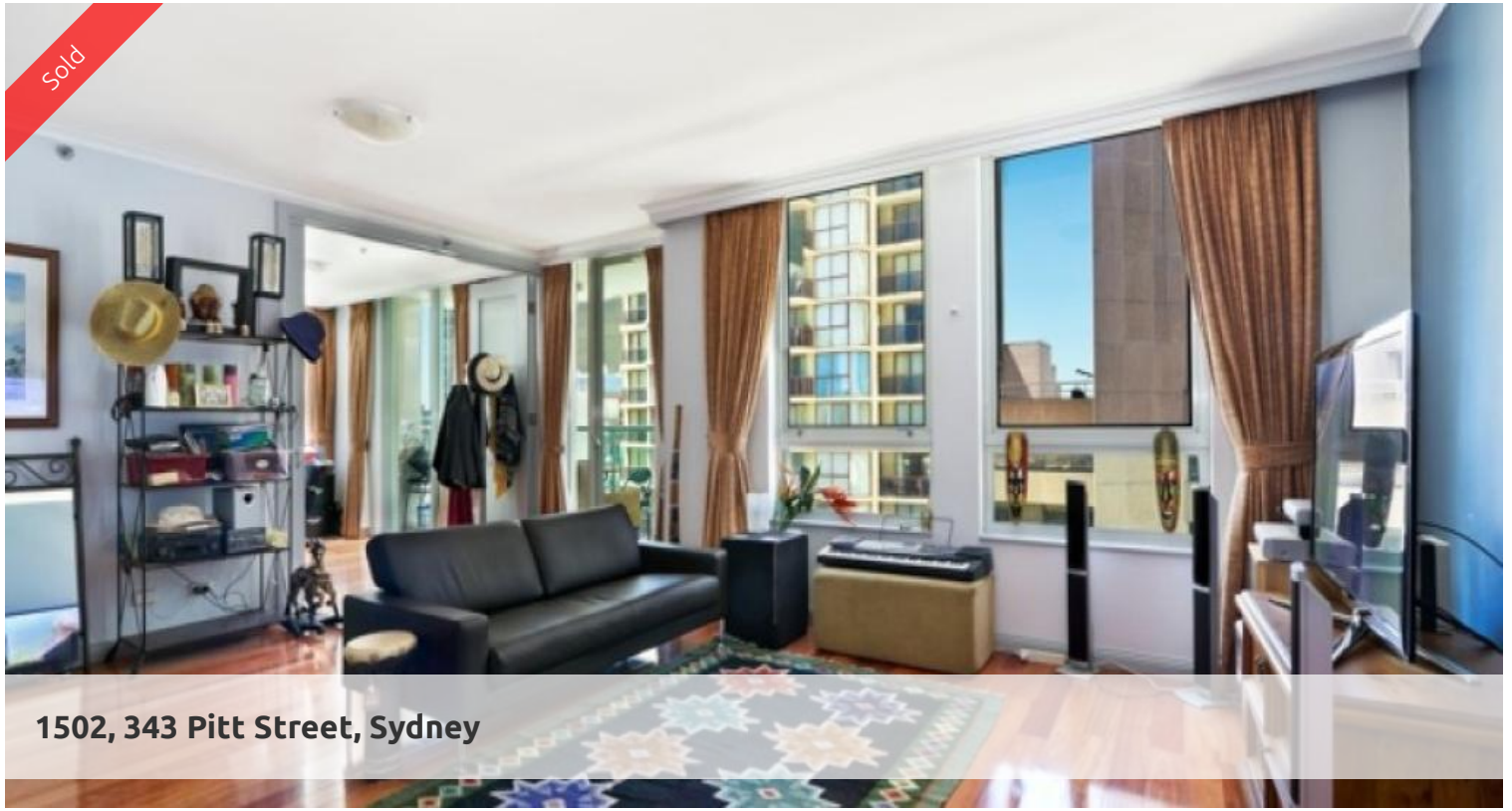

1502, 343 Pitt Street, Sydney

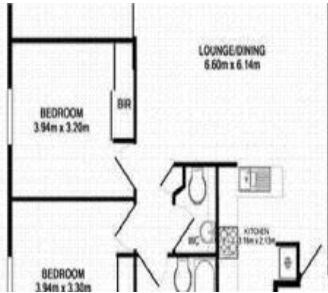

Discerning Buyers Affordable Oversized Apartment With A Flexible Layout

Great investment current rental return \$800 per week
Situated in the popular Century Tower is this 2 bedroom + study apartment with north east aspect. Features include large balcony with oversized living/dining and large study or home office, gourmet kitchen with stainless steel appliances and internal laundry. The building is renowned for its quality, providing 24 hour security and recreational facilities of the highest standard. Easy walking distance to Darling Harbour, Cockle Bay Wharf, Chinatown, World Square and Town Hall.
Open For Inspection: By Appointment
Rental return \$800 per week
Levies \$1180 per quarter
Water \$142.90 per Quarter
Council \$206.60 per Quarter

The above information provided has been furnished to us by the vendor/s. We have not verified whether or not that information is accurate and do not have any belief in one way or the other in its accuracy. We do not accept any responsibility to any person for its accuracy and do no more than pass it on. All interested parties should make and rely upon their own inquiries in order to determine whether or not this information is in fact accurate.



Price	SOLD
Property Type	Residential
Property ID	1715
Land Area	0 m2
Floor Area	92.90 m2

Agent Details

William Chen - 0430 026 436
william@greenciff.com.au

Office Details

Greenciff Sydney Kent St
Level 10/488 Kent Street Sydney NSW
2000 Australia
02 8076 8006

greenciff
Inner city specialists