

Sold

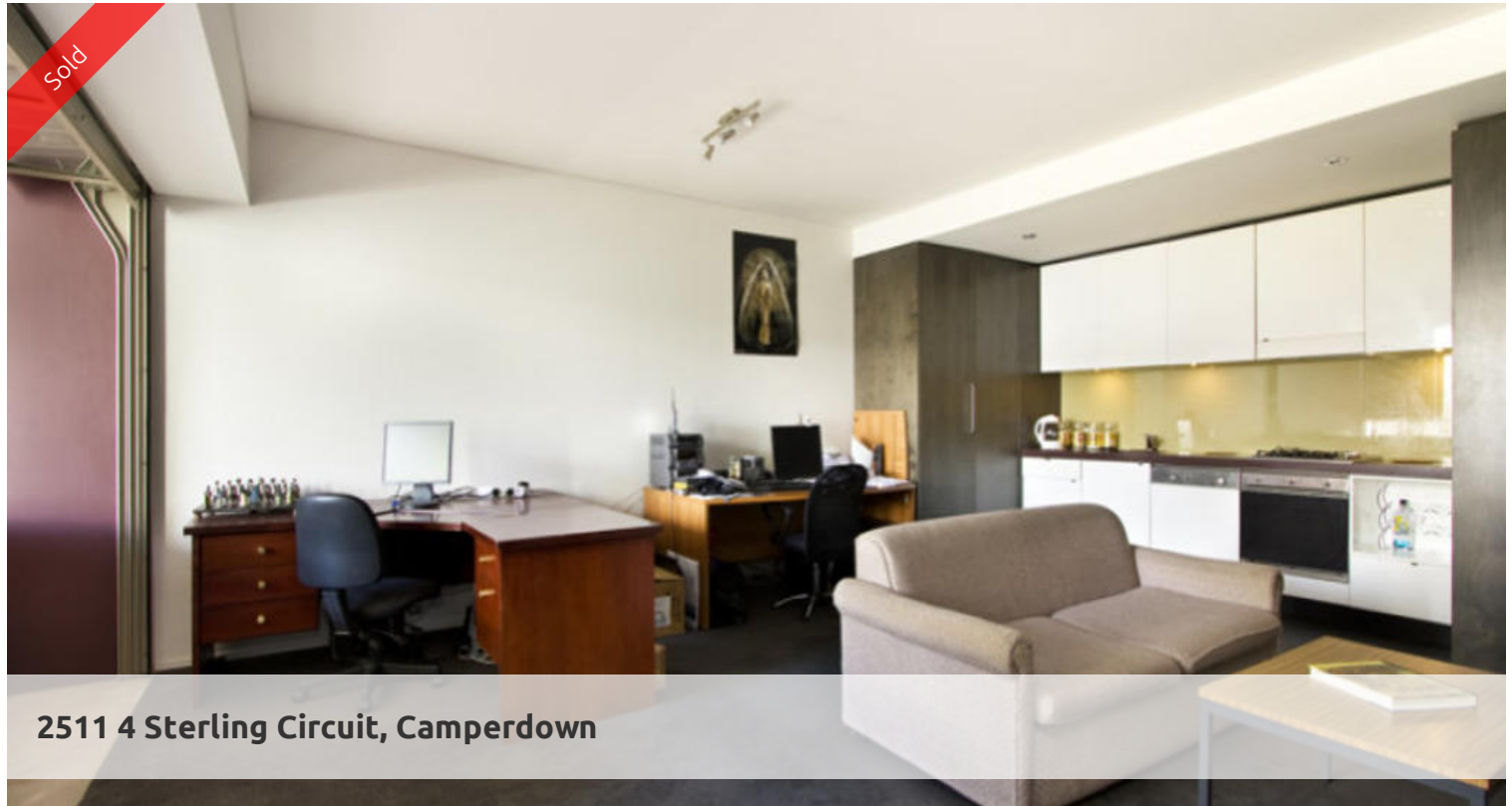

2511 4 Sterling Circuit, Camperdown

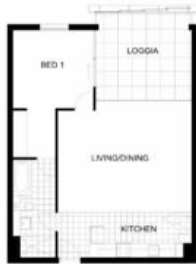

LOGGIA APARTMENT IN VIE 2 OVERLOOKING VILLAGE GREEN

Ideal opportunity for first home buyers or astute investors

- Prized east position, bathed in natural light
- Thoughtful open plan to maximize internal/external space
- Dual access bathroom with bath and separate shower
- Modern kitchen with Smeg appliances & ample storage
- Large windows allow for cross flow ventilation
- Loggia with shutters for privacy and comfort
- Oversized bedroom with built-ins
- Secure under cover parking
- Quiet position

Enjoy all the lifestyle benefits of an established estate, cafe, restaurants, 25 meter indoor pool and gym. 24/7 on-site security.

Super peaceful and convenient location only moments to Glebe and Annandale Village, CBD, University, Broadway Shopping Centre, theatres, cafes and vibrant shopping.

Strata rates

The above information provided has been furnished to us by the vendor/s. We have not verified whether or not that information is accurate and do not have any belief in one way or the other in its accuracy. We do not accept any responsibility to any person for its accuracy and do no more than pass it on. All interested parties should make and rely upon their own inquiries in order to determine whether or not this information is in fact accurate.

1 bed 1 bath 1 car

Price	SOLD
Property Type	residential
Property ID	1666
Land Area	0 m2

Agent Details

Nicola Ericson - 0410 433 445
nicola@greenciff.com.au

Office Details

Greencliff Sydney Kent St
Level 10/488 Kent Street Sydney NSW
2000 Australia
02 8823 8818

greenciff
Inner city specialists